

EXB-8200 8mm Cartridge Tape
Subsystem

Illustrated Parts Catalog

Copyright

Copyright 1989 by EXABYTE Corporation. All rights reserved. This item and the information contained herein are the property of EXABYTE Corporation. No part of this document may be reproduced, transmitted, transcribed, stored in a retrieval system, or translated into any language or computer language in any form or by any means, electronic, mechanical, magnetic, optical, chemical, manual, or otherwise, without the express written permission of EXABYTE Corporation, 1745 38th Street, Boulder, Colorado 80301.

Disclaimer

EXABYTE Corporation makes no representation or warranties with respect to the contents of this document and specifically disclaims any implied warranties of merchantability or fitness for any particular purpose. Further, EXABYTE Corporation reserves the right to revise this publication without obligation of EXABYTE Corporation to notify any person or organization of such revision or changes.

EXABYTE is a registered trademark of EXABYTE Corporation.

Revision History

Rev No.	Date	Revision Information
000	April 1988	Initial release.
001	May 1988	Part number changes based on ECs.
002	August 1988	Entire catalog revised and reformatted.
003	August 1988	Revised part number descriptions.
004	October 1988	Initial release of MS card.
005	15 October 1989	Entire catalog revised and reformatted.

(This Page Intentionally Left Blank.)

Table of Contents

1. Introduction	1
2. Parts Ordering	1
3. Part Number Format	1
4. Standard Part Number Description	2
4.1. Top Level Assemblies	3
4.2. Subassemblies	4
4.2.1. PCB Subassemblies	4
4.2.2. Mechanical Subassemblies	5
4.3. Component Part Numbers	6
4.4. Unique Configuration Part Numbers	7
4.4.1. Unique Subassemblies	7
4.4.2. Unique Component Parts	8
5. Field Spares Designation	9
6. EXB-8200 Parts Illustrations	10
Figure 1	11
Cover, SV Card	
Cover, Top	
Housing, Main	
Insulator Pad, SV Card	
#2-56 x .250 Panhead Taptite Screw	
#4-20 x .250 Panhead Plastite Screw	
Top Cover Seal	
Figure 2	12
Card Retainer (LH)	
Card Retainer (RH)	
Deck Assembly	
CD Card Assembly	
DB Card Assembly	
DF Card Assembly	
DS Card Assembly	
MS Card Assembly	
MX Card Assembly	
RW Card Assembly	
SV Card Assembly	

Figure 3 13
 Door Assembly
 Door Retaining Plate
 Face Plate

Figure 4 14
 Deck Hanger
 Deck Hanger Bracket

7. EXB-8200 Parts Name and Number List 15

1. Introduction

This Illustrated Parts Catalog (IPC) provides the following:

- General information about EXABYTE part numbering formats and definitions.
- Illustrations of the EXB-8200 Cartridge Tape Subsystem and where each part is located.
- A list of part numbers for all EXB-8200 parts that can be ordered.

2. Parts Ordering

This catalog provides illustrations of the EXB-8200 and where each part is located. Use this catalog to help you determine part name(s) and number(s) for the part(s) you want to order.

To order part(s), follow the procedures outlined in the *EXABYTE General Business Practices for OEM/VARs and Distributors* in these Spare Parts sections:

- Purchase Order for Spare Parts (Section 2)
- Emergency Purchase Order for Spare Parts and Equipment Repair Services (Section 7)
- Priority Orders for Equipment and Spare Parts Repair (Section 8)
- Routine Orders for Spare Parts (Section 9)
- Repair Orders (Section 11)

3. Part Number Format

The standard part number used by EXABYTE Corporation consists of a six-digit number followed by a three-digit number, separated by a hyphen. For example:

NNNNNN-NNN

In normal usage, the three digits following the hyphen represent the compatibility and revision level of the part.

4. Standard Part Number Description

The definition of the components of the standard part number is different based on the level at which the part number is being applied.

The levels at which part numbers are used by EXABYTE are:

- Top Level Assemblies (TLA)
- Subassemblies
- Component Parts
- Unique Configuration Parts

The following pages provide a more detailed description of the part number structure as it relates to each definition.

4.1. Top Level Assemblies

The top level assemblies are used to denote the product family.

The part number for the top level assemblies is structured as follows:

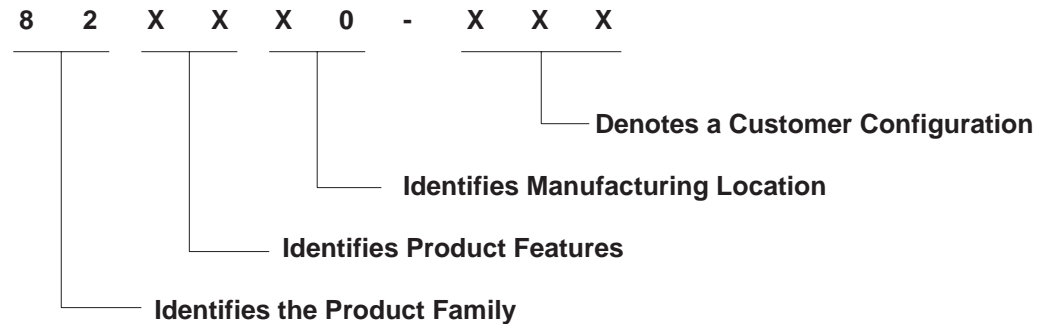

The first two digits are the product family number.

The next two digits identify product features, as follows:

- 00 EXB-8200 (standard)
- 01 EXB-8200 with DS option (differential)

The next two digits identify the manufacturing location, as follows:

- 10 EXABYTE
- 20 Kubota

The three digits following the hyphen designate a specific customer configuration.

4.2. Subassemblies

The subassemblies are divided into two categories:

- Printed circuit board (PCB) subassemblies
- Mechanical or fabricated part assemblies

4.2.1. PCB Subassemblies

The part number for the PCB subassemblies is structured as follows:

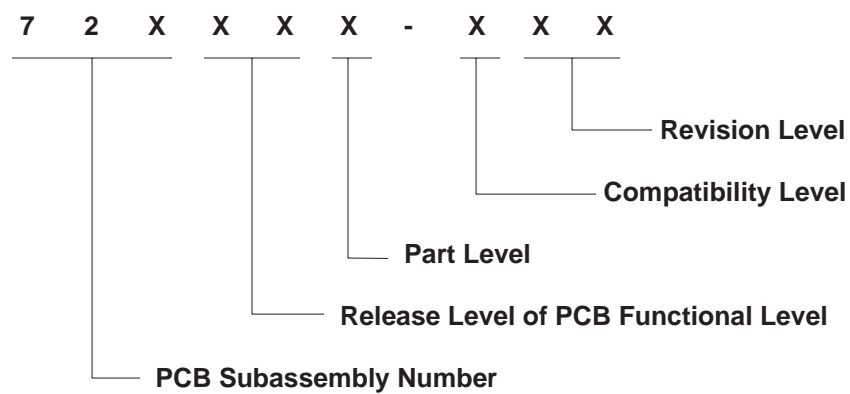

The first three digits designate the subassembly (e.g., DB Card, MX Card, etc.).

The next two digits identify the release of major design modifications to the PCB subassembly. These are modifications which affect the actual function of the PCB without changing its purpose.

The next digit is the level of the PCB. This indicates all of the physical modifications made to the PCB layout that have been incorporated into the board layout.

The next digit is an alpha character that designates the compatibility level of the current revision with previous revisions. All PCBs of the same type and with the same compatibility letter are considered functionally compatible.

The last two digits represent the revision level associated within that compatibility level.

4.2.2. Mechanical Subassemblies

The part number for the mechanical subassemblies is structured as follows:

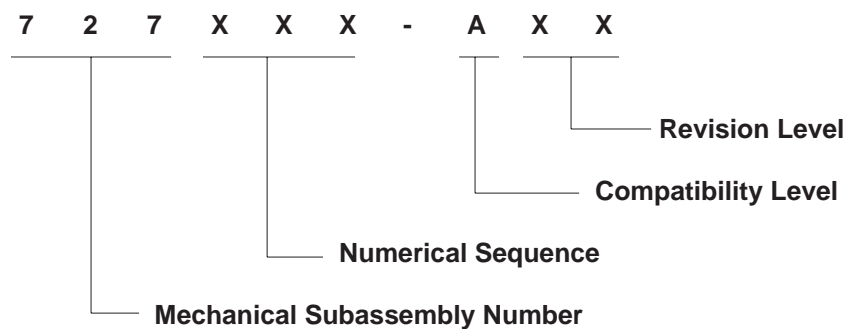

The first three digits are used to designate the subassembly.

The next three digits represent a numerical sequence.

The next digit is an alpha character which designates the compatibility level of the current revision with previous revisions. All subassemblies of the same type and with the same compatibility letter are considered functionally compatible.

The last two digits represent the revision level associated within that compatibility level.

4.3. Component Part Numbers

Component part numbers fall into two categories:

- Component parts designed and fabricated for EXABYTE
- Parts purchased through normal supply channels.

The part number for the component parts is structured as follows:

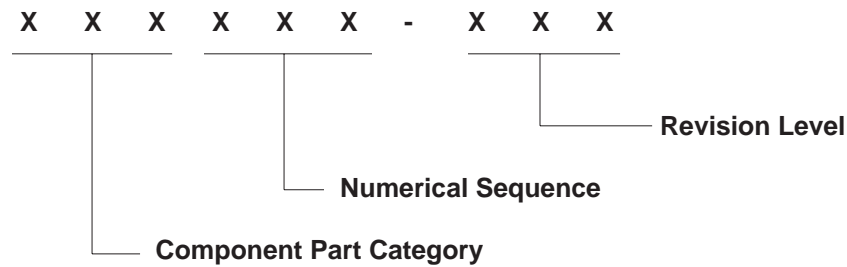

The first three digits are the component part category, which groups similar parts together (e.g., sheet metal, screws, resistors, etc.).

The next three digits are a numerical sequence within the category.

The three digits following the hyphen are the revision level.

All parts purchased through normal supply channels have a six-digit part number without a revision designation.

Those parts fabricated for EXABYTE contain the revision level. They may have a three-digit numeric revision level or the compatibility revision level. The compatibility revision level may be used for those parts considered field replaceable.

4.4. Unique Configuration Part Numbers

The unique configuration part numbers are assigned for subassemblies and for component parts.

4.4.1. Unique Subassemblies

The part number for the unique configuration subassemblies is structured as follows:

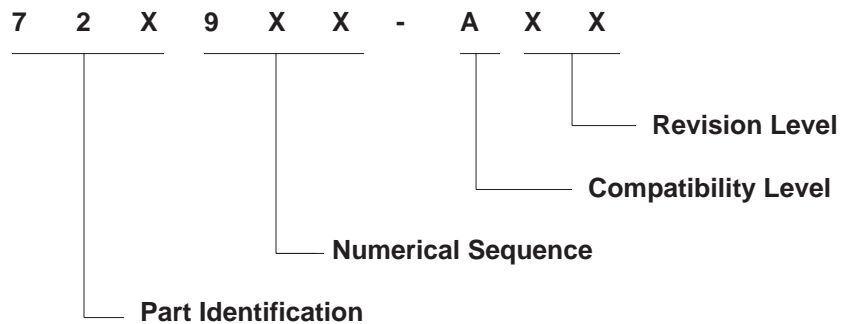

The first three digits identify the unique configurable subassembly. A configurable subassembly may be for function or for color and logos. These digits serve as a cross-reference to the standard part number.

The next three digits are a numerical sequence within the category.

The next digit is an alpha character which designates the compatibility level of the current revision to previous revisions. All PCBs of the same type and with the same compatibility letter are considered functionally compatible.

The last two digits represent the revision level associated within that compatibility level.

4.4.2. Unique Component Parts

The part number for the unique configuration component parts is structured as follows:

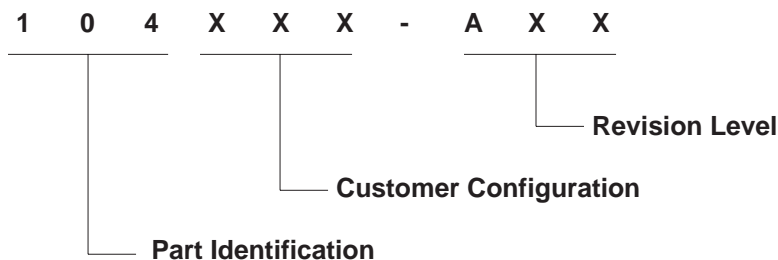

The first three digits identify the unique configurable component part. These digits serve as a cross-reference to the standard part number.

The next three digits designate a specific customer configuration. These digits are cross-referenced to the TLA number.

The next three digits designate the revision level of the component part. They may consist of a three-digit numeric revision level or the compatibility revision level. The compatibility revision level may be used for those parts considered field replaceable.

5. Field Spares Designation

The part numbers described previously in this document may have a special Field Spares designation. Field spares part numbers begin with the letter F. Parts so designated have had additional testing and burn-in before being placed in the field spares crib.

The following subassemblies supplied from the Field Spares crib carry the Field Spares designation:

- Deck Assembly
- CD Card
- DB Card
- DF Card
- DS Card
- MS Card
- MX Card
- RW Card
- SV Card

6. EXB-8200 Parts Illustrations

This section contains illustrations of the EXB-8200 parts that can be ordered. Section 7 contains the part name and number list that you can use when ordering parts for the EXB-8200.

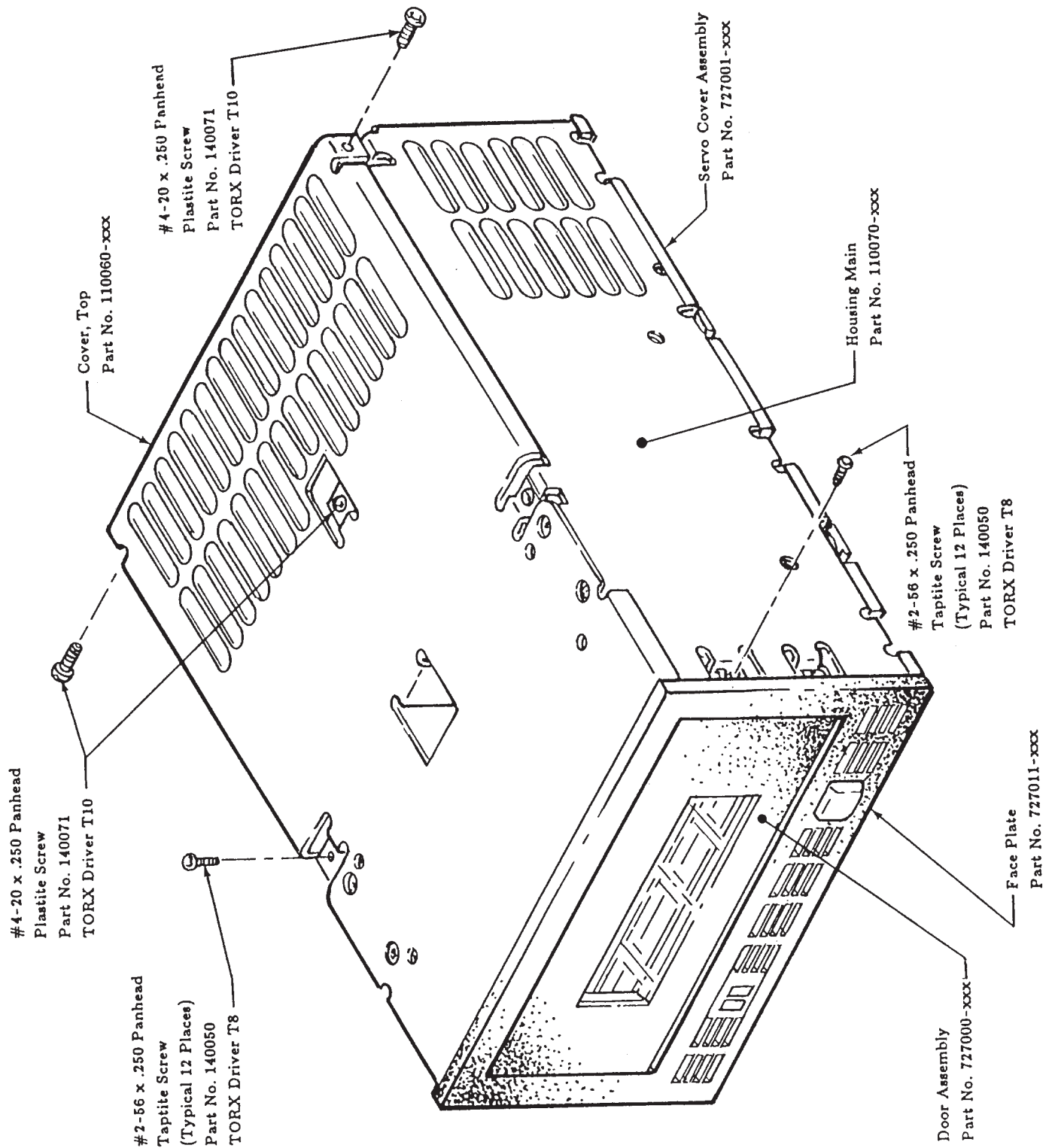

Figure 1

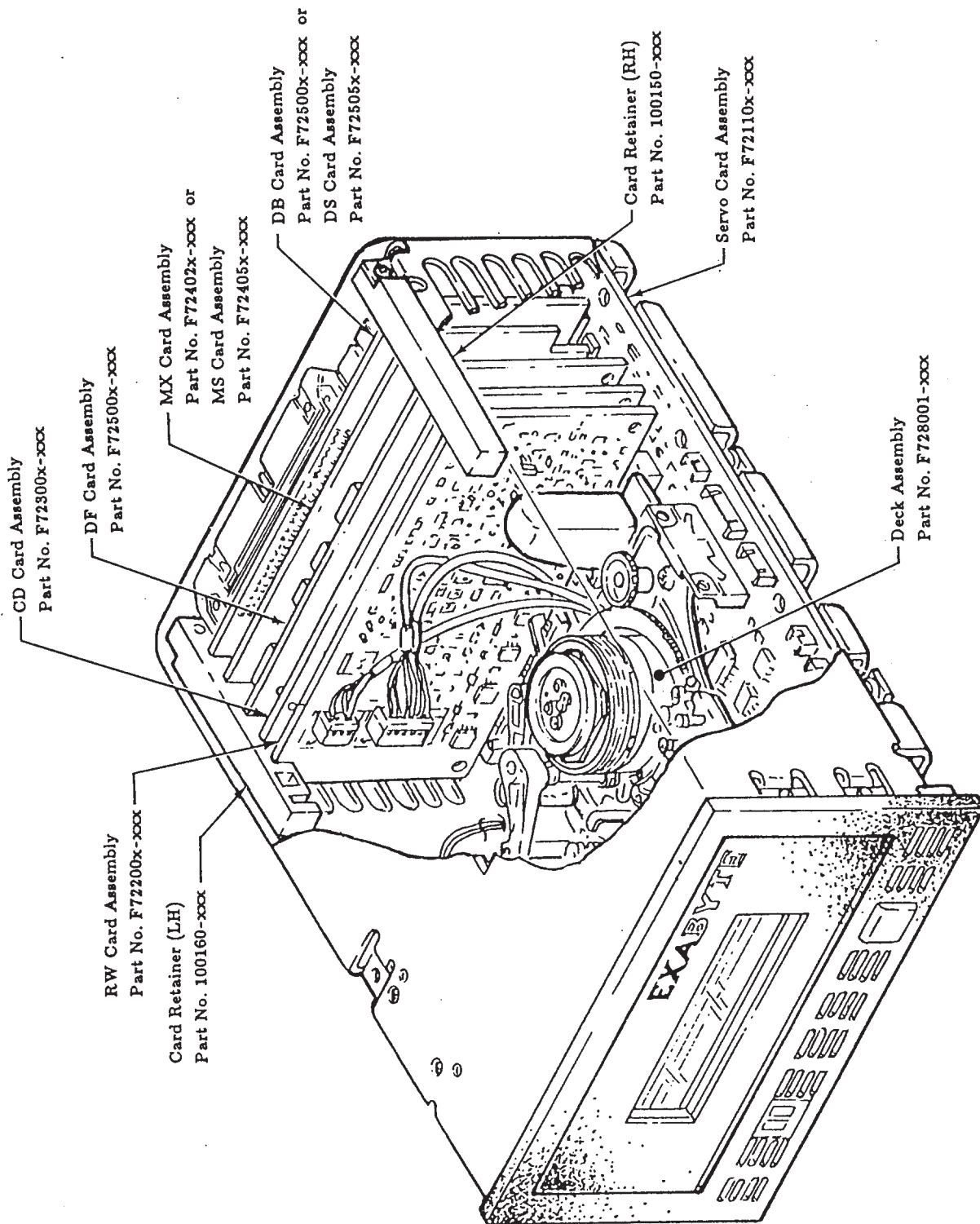

Figure 2

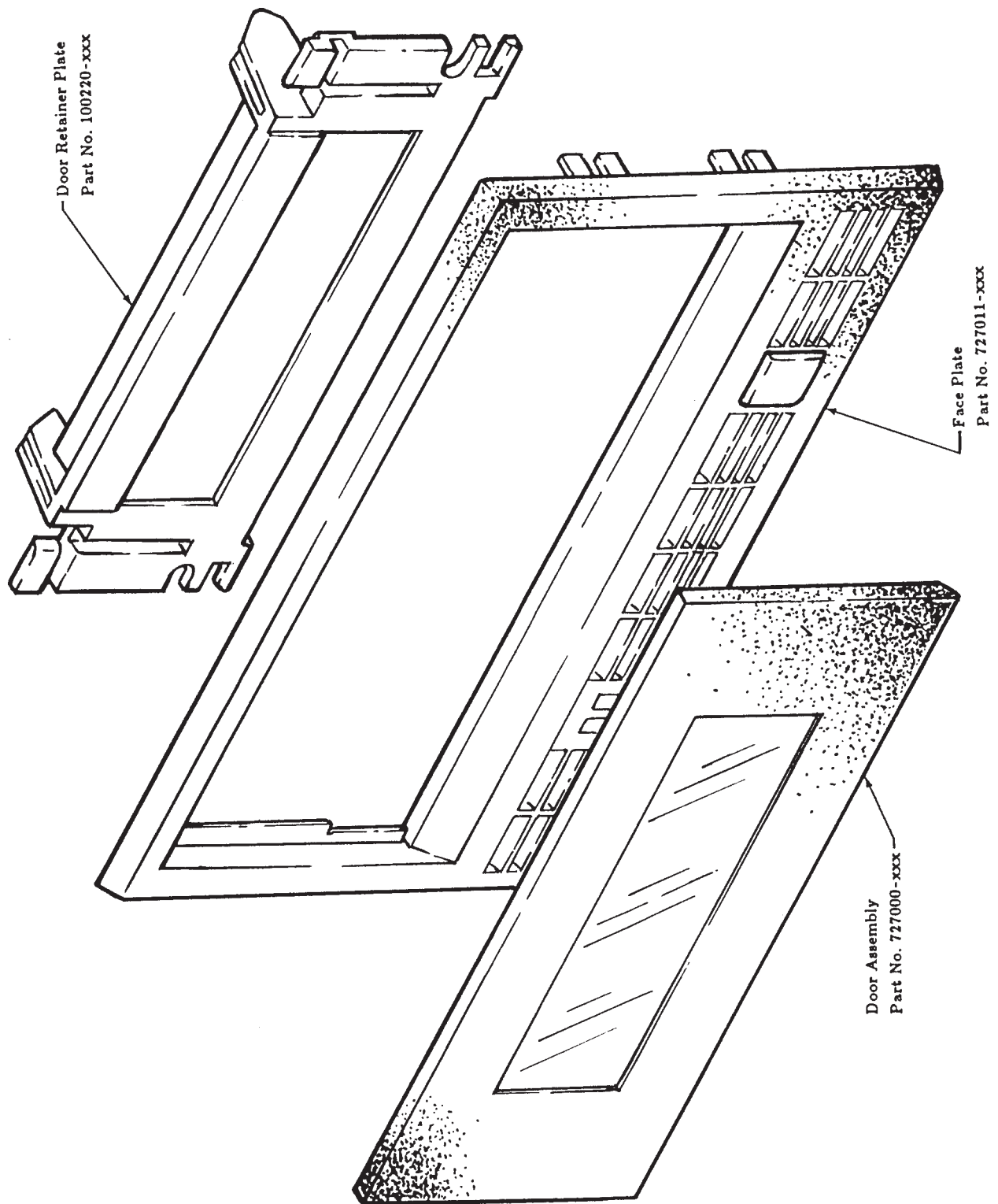

Figure 3

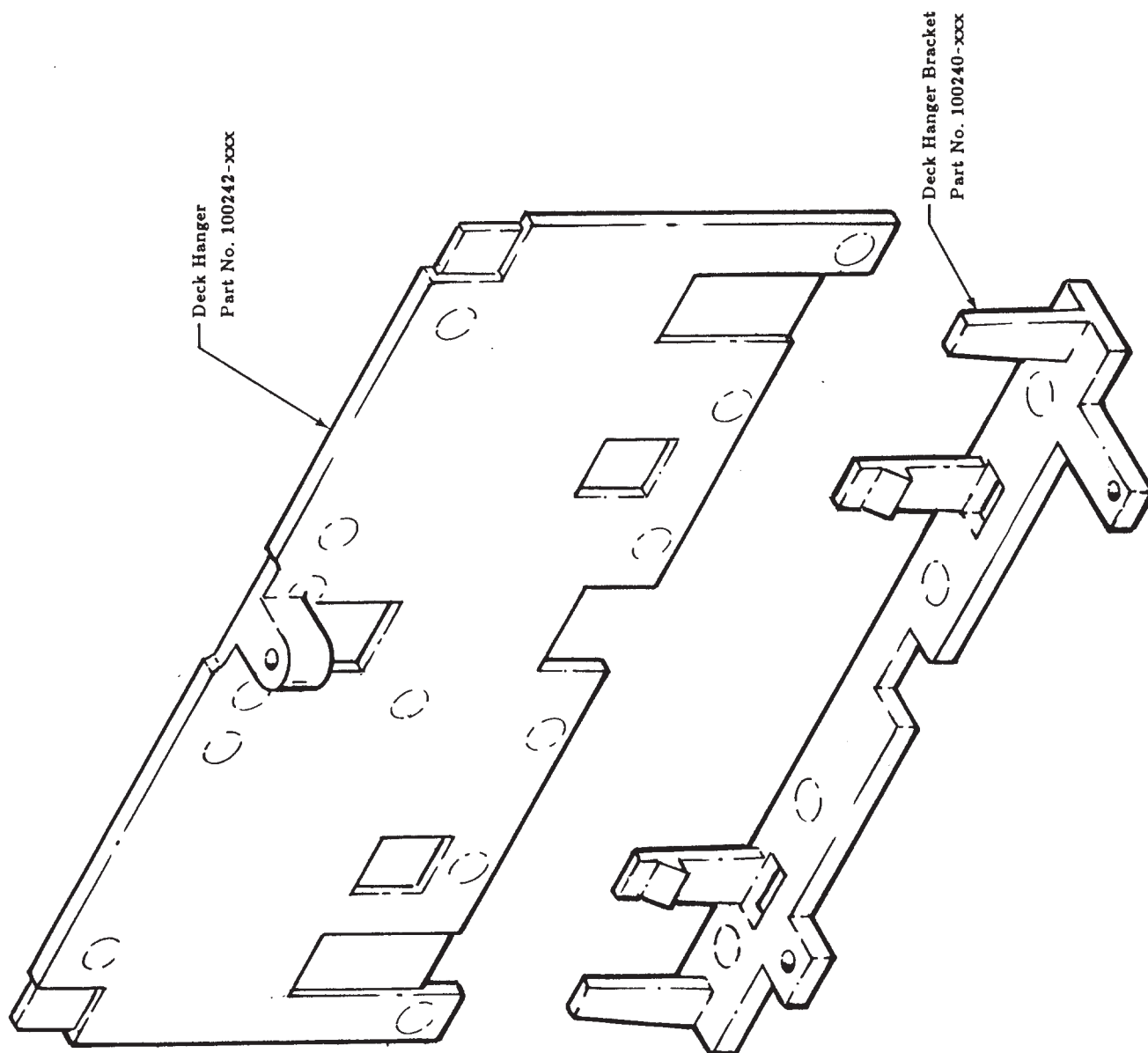

Figure 4

7. EXB-8200 Parts Name and Number List

The following page contains part numbers for all EXB-8200 parts that can be ordered. Before you order part(s) for the EXB-8200, make note of the appropriate part numbers from the following list. To order, call EXABYTE Sales Administration at (303) 442-4333.

Description	Part Number
-------------	-------------

Figure 1

Cover, SV Card	110030-A01
Cover, Top	110060-A01
Housing, Main	110070-A01
Insulator Pad, SV Card	180090-A01
#2-56 x .250 Panhead Taptite Screw	140050
#4-20 x .250 Panhead Plastite Screw	140071
Top Cover Seal	180119-000

Figure 2

Card Retainer (LH)	100160-A00
Card Retainer (RH)	100150-A00
Deck Assembly	F728000-C03
CD Card Assembly	F723002-A08
DB Card Assembly	F725003-A05
DF Card Assembly	F726001-A07
DS Card Assembly	F725052-A01
MS Card Assembly	F724050-A00
*MV Card Assembly	(see * below)
MX Card Assembly	
Level 1	F730001-A03
Level 2	F730002-A03
RW Card Assembly	F722002-A09
SV Card Assembly	
Level 1	F739002-A04
Level 2	F739003-A04

Figure 3

Door Assembly	727000-A02
Door Retaining Plate	100220-A01
Face Plate	727011-A03

Figure 4

Deck Hanger	100242-A01
Deck Hanger Bracket	100240-A00

* MV cards have been replaced by the MX card assembly.

Note: Should your contract require unique part numbers, software, or configuration of the EXB-8200, refer to the *EXABYTE Pricing Guide* (supplied by EXABYTE Sales Administration) for the correct part number.